

L5450DT -> HYDRAULIC SYSTEM -> T10401 HYDRAULIC PUMP ## L5450DT

Update Date: 11/26/2013, Printing Date: 04/03/2019

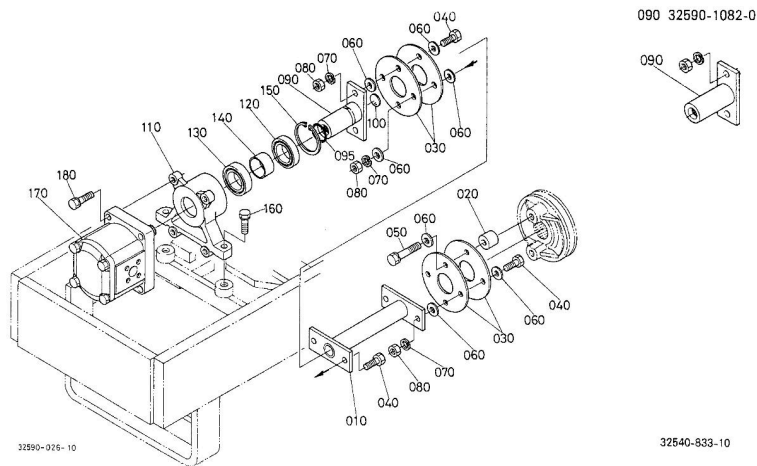

L5450DT -> HYDRAULIC SYSTEM -> T10401 HYDRAULIC PUMP ## L5450DT

Update Date: 11/26/2013, Printing Date: 04/03/2019

Interchangeable =, Not Interchangeable NI, New for Old >>, Old for New <<

No	Part Number	Part Name	Qty	RoundUp	IC	S/N	Remarks	Kg
010	32590-10810	SHAFT COUPLING	1					1.364
020	32590-10800	COLLAR	2					0.099
030	32590-10850	PLATE COUPLING	4		=	>=60502		0.0418
030	76521-31510	PLATE, COUPLING	4			<=60501		0.044
040	01173-51025	HEX. BOLT	6					0.0462
050	01133-51050	BOLT, SEMS	2					0.077
060	04013-50100	WASHER, PLAIN	14					0.0088
070	04512-60100	WASHER, SPRING	6					0.0044
080	02118-50100	HEX. NUT	6					0.011
090	32590-10820	SHAFT COUPLING	1			<=60874		0.748
090	32590-10823	SHAFT COUPLING	1		>>	>=60875		0.77
095	04811-00240	RING	1			>=60875		0.0022
100	06311-75020	PLUG, EXPANSION	1					0.0088
110	32590-10890	BASE PUMP	1					2.244
120	32590-10830	BEARING, BALL	1					0.22
130	31351-25140	BEARING, BALL	1					0.242
140	32590-10840	COLLAR	1					0.0704
150	04611-00520	CIR-CLIP, INTERNAL	1					0.0198
160	01123-51030	BOLT, SEMS	2					0.055
170	33740-82200	PUMP HYDRAULIC	1			<=60323		0.0
170	33740-82202	PUMP HYDRAULIC	1		>>	>=60324		6.6
180	01123-50835	BOLT, SEMS	4					0.044