

L345DT -> ENGINE -> 010000 CRANKCASE ## L345DT

Update Date: 06/13/2012, Printing Date: 05/22/2021

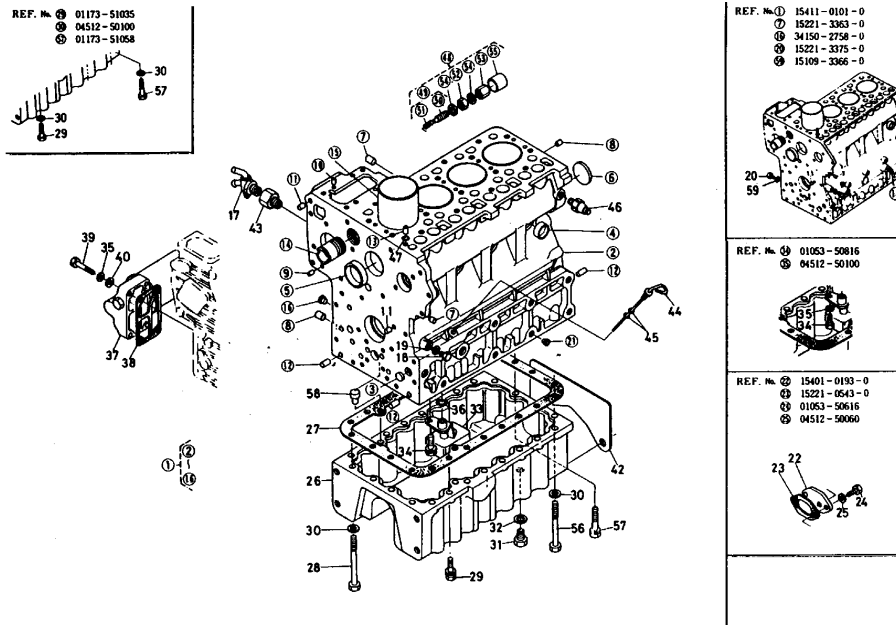

L345DT -> ENGINE -> 010000 CRANKCASE ## L345DT

Update Date: 06/13/2012, Printing Date: 05/22/2021

Interchangeable =, Not Interchangeable NI, New for Old >>, Old for New <<

No	Part Number	Part Name	Qty	RoundUp	IC	S/N	Remarks	Kg
001	15411-01010	ASSY CRANKCASE	1			<=1017		0.0
001	15411-01013	ASSY CRANKCASE	1			>=1018		119.9
003	06311-75018	PLUG	3					0.0088
004	15221-03380	CAP,SEALING	6					0.0374
005	15221-03390	CAP,SEALING	2					0.066
006	06311-75045	PLUG,EXPANSION	1					0.0572
007	15221-33630	PLUG PIN	6			<=1017		0.0022
007	15221-33630	PLUG PIN	5			>=1018		0.0022
007	15521-96020	PLUG	6			>=2238		0.0066
008	15221-33640	PLUG PIN	1					0.0066
008	15521-96030	PLUG	2			>=2238		0.0154
009	05012-00408	PIN,STRAIGHT	2					0.0022
010	05012-00609	PIN,STRAIGHT	2					0.0066
011	05012-00612	PIN, STRAIGHT	2					0.0066
012	05012-01018	PIN,STRAIGHT	3					0.0264
013	15221-33650	PIN,PIPE	1					0.0088
014	15221-72840	PIPE WATER	1					0.1716
015	15221-02310	LINER CYLINDER	4					1.276
016	34150-27580	PLUG	5			<=1017		0.0022
016	34150-27580	PLUG	1			>=1018		0.0022
017	14412-73110	COCK,DRAIN	1					0.198
018	15221-33610	PLUG	1					0.0198

L345DT -> ENGINE -> 010000 CRANKCASE ## L345DT

Update Date: 06/13/2012, Printing Date: 05/22/2021

Interchangeable =, Not Interchangeable NI, New for Old >>, Old for New <<

No	Part Number	Part Name	Qty	RoundUp	IC	S/N	Remarks	Kg
019	15021-33660	PACKING	1					0.0022
020	15221-33750	PLUG	1			<=1017		0.0704
020	15521-33630	PLUG PIN	1			>=1018		0.0066
020	15521-33620	PLUG	1			<=1617		0.0088
020	15521-96010	PLUG	1			>=1618		0.022
021	32210-27580	PLUG,BLIND	13			>=1018		0.0022
022	15401-01930	COVER	1			<=1017		0.198
023	15221-05430	GASKET	1			<=1017		0.0
024	01053-50616	HEX.BOLT	2			<=1017		0.011
025	04512-50060	WASHER,SPRING LOCK	2			<=1017		0.0022
026	15415-01610	OIL PAN	1					33.88
027	15401-01620	GASKET OIL PAN	1					0.0
028	15411-91010	BOLT	4					0.0
029	01173-51035	HEX.BOLT	16			<=1017		0.055
029	01133-51035	BOLT,SEMS	16			>=1018		0.066
030	04512-50100	WASHER,SPRING LOCK	24			<=1017		0.0066
030	04512-50100	WASHER,SPRING LOCK	6			>=1018		0.0066
031	15221-33750	PLUG	2					0.0704
032	15109-33660	GASKET	2					0.0022
033	15411-32110	FILTER(OIL)	1					0.528
034	01053-50816	HEX.BOLT	1			<=1017		0.0242
034	01123-50816	BOLT,SEMS	1			>=1018		0.0242
035	04512-50080	WASHER,SPRING LOCK	5			<=1017		0.0044
035	04512-50080	WASHER,SPRING LOCK	4			>=1018		0.0044
036	04811-00160	O RING	1					0.0022
037	15402-32020	ASSY FILTER OIL	1					0.0
038	15213-32320	GASKET	1					0.0
039	15402-91010	BOLT	4					0.044
040	04012-50080	WASHER,PLAIN	4					0.0022
041	15521-33610	PLUG	1			<=2237		0.0044
042	15415-04690	SHIM	2					0.066
043	15291-73160	JOINT DRAIN COCK	1			>=1018		0.088
044	15221-36410	GAUGE OIL	1					0.0616
045	04811-00050	O RING	2					0.0022
046	15221-39010	SWITCH OIL	1					0.0
047	15221-33700	O RING	1					0.0022
048	15401-54090	ASSY APPARATUS,I/D.	1			<=1017		0.0836
048	15411-54090	ASSY APPARATUS IDLE	1			>=1018		0.088
049	15401-54100	ASSY BOLT ADJUSTING	1			<=1017		0.022
049	15411-54100	ASSY BOLT ADJUSTING	1			>=1018		0.0264

L345DT -> ENGINE -> 010000 CRANKCASE ## L345DT

Update Date: 06/13/2012, Printing Date: 05/22/2021

Interchangeable =, Not Interchangeable NI, New for Old >>, Old for New <<

No	Part Number	Part Name	Qty	RoundUp	IC	S/N	Remarks	Kg
050	15401-54250	BOLT ADJUSTING	1			<=1017		0.022
050	15521-54250	BOLT ADJUSTING	1			>=1018		0.0
051	15401-54260	SPRING	1			<=1017		0.0022
051	15411-54260	SPRING	1			>=1018		0.0022
052	15401-92010	NUT	1					0.022
053	15401-92330	NUT CAP	1			<=1017		0.022
053	15521-92330	NUT	1			>=1018		0.044
054	15021-33660	PACKING	2					0.0022
055	15401-54270	CAP	1			<=1017		0.0088
055	15521-54270	CAP	1			>=1018		0.0066
056	15415-91010	BOLT	2					0.165
057	01173-51050	HEX.BOLT	2					0.077
057	01133-51050	BOLT,SEMS	2			>=1001		0.077
058	15411-94510	PIN	2					0.022
059	15109-33660	GASKET	1					0.0022