

## U27-4 -&gt; ELECTRICAL SYSTEM -&gt; B40602 LAMP ## U27-4

Update Date: 05/25/2020, Printing Date: 06/18/2020

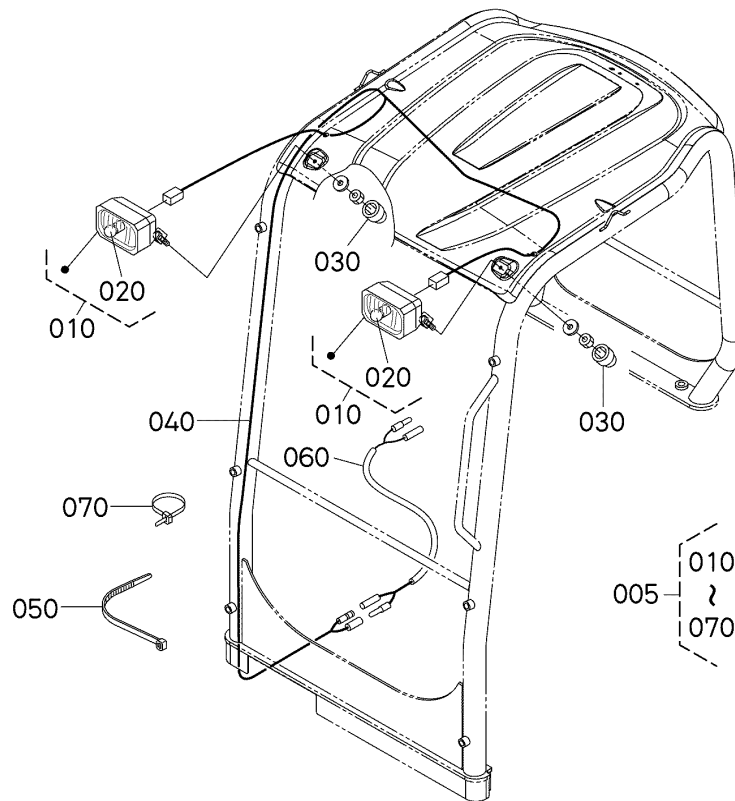

RH418-170-10

## U27-4 -&gt; ELECTRICAL SYSTEM -&gt; B40602 LAMP ## U27-4

Update Date: 05/25/2020, Printing Date: 06/18/2020

Interchangeable =, Not Interchangeable NI, New for Old &gt;&gt;, Old for New &lt;&lt;

| No  | Part Number | Part Name            | Qty | RoundUp | IC | S/N | Remarks | Kg     |
|-----|-------------|----------------------|-----|---------|----|-----|---------|--------|
| 005 | RH418-99800 | CANOPY(LIGHT,KIT_NA) | 1   |         |    |     |         | 0.0    |
| 010 | RG518-46270 | WORKING LIGHT        | 2   |         |    |     |         | 1.012  |
| 020 | RG138-46830 | BULB (12V/55W)       | 2   |         |    |     |         | 0.011  |
| 030 | 69443-47570 | CAP                  | 2   |         |    |     |         | 0.0022 |
| 040 | RG158-53494 | W/H(CANOPY,4P)       | 1   |         |    |     |         | 0.0    |
| 050 | RG059-36130 | BAND CORD            | 7   |         |    |     |         | 0.011  |
| 060 | RH418-53480 | W/H(2,CANOPY,4P)     | 1   |         |    |     |         | 0.0    |
| 070 | 69481-41260 | BAND CORD            | 1   |         |    |     |         | 0.0066 |