

BELTS AND IDLER ASSEMBLY

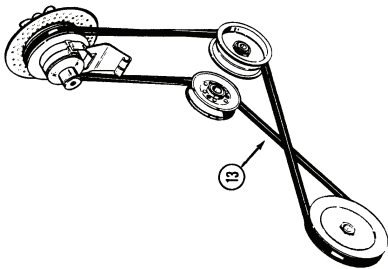
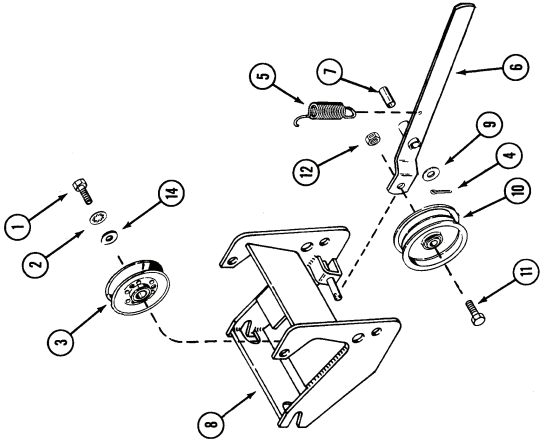

BELT ILLUSTRATION AS VIEWED FROM FRONT LEFT SIDE.

BELTS AND IDLER ASSEMBLY

REF.	PART NO.	DESCRIPTION	REQ'D
1	113-206	BOLT - 3/8 x 3/4" NC hex ZP	1
2	193-68	WASHER - 3/8" internal tooth	1
3	C25370	PULLEY - idler	1
4	132-318	PIN - cotter	1
5	C16870	SPRING - idler	1
6	C16853	ARM - idler	1
7	C16714	BUSHING - idler arm	1
8	C25565	FRAME - idler (also use two C25580 for J, K, L80 - J, K, L84)	1
9	195-533	WASHER - 1/2" ZP	1
10	C26090	PULLEY - backside idler	1
11	113-410	BOLT - 1/2 x 1-3/4" NC hex ZP	1
12	131-1182	NUT-lock 1/2" NC hex ZP	1
13	C23949	BELT - J80 and J84 (use with 200 series tractors)	1
13	C23950	BELT - J84 (use with 400 series tractors)	1
13	C23538	BELT - K, L, M, N, P, R, S80 - K, L, M, N, P, R, S84 (use with 200 series tractors)	1
13	C23539	BELT - K, L, M, N, P, R, S84 (use with 400 series tractors)	1
14	195-103	WASHER - 3/8"	1

NOTE: If this snow caster has been converted to fit on 3000, 4000 series tractors, see model SB38G and SB48 snow caster for parts.