

**CONDENSER [CAB TYPE]**

↔ Interchangeable; ≠ not interchangeable; ← new for old; → old for new

REF.No	Part No.	Description	Q'ty	S.No.	I/C	REMARKS	Weight (kgf)	Weight (lb)
010	01123-60816	BOLT	6				0.01	0.022
020	TA240-87720	NET CONDENSER	1				0.05	0.11
030	TA240-87020	KIT AIR CONDITIONER	1				9.1	20.02
040	TA240-87280	ASSY CONDENSER	1				3.4	7.48
050	T0070-79270	TANK RECEIVER	1				0.7	1.54
060	3F260-56820	HOLDER RECEIVER	1				0.31	0.682
070	TA240-87030	KIT AIR CONDITIONER	1				4.7	10.34
080	T0320-87110	HOSE SUCTION	1				1.57	3.454
090	33760-56960	O RING	2				0.001	0.0022
100	T0320-87120	HOSE RIQUID	1				0.83	1.826
110	33760-56980	O RING	2				0.001	0.0022
120	TA240-72230	HOSE DISCHARGE	1				0.31	0.682
130	33760-56970	O RING	2				0.001	0.0022
140	TA240-72260	TUBE RIQUID	1				0.055	0.121
150	33760-56960	O RING	2				0.001	0.0022
160	T0270-87170	ADAPTER RECIVER	1				0.055	0.121
170	33760-56960	O RING	1				0.001	0.0022
180	36530-50260	INSULATOR	3				0.01	0.022
190	01023-50625	BOLT	2				0.007	0.0154
200	01754-50630	BOLT FLANGE	2				0.01	0.022
210	T0270-87900	CLAMP HOSE	1				0.042	0.0924
220	31351-18790	BOLT FLANGE	1				0.007	0.0154
230	TA140-74640	BRACKET HOSE	1				0	0
240	01754-50816	BOLT FLANGE	2				0.011	0.0242
250	T0270-50230	CLAMP HOSE	1				0.021	0.0462
260	01754-50816	BOLT FLANGE	1				0.011	0.0242
270	T0070-74893	COVER HEATER HOSE	1				0.016	0.0352
280	TA140-87730	PLATE	1				0.08	0.176
290	01754-50616	BOLT FLANGE	1				0.006	0.0132
300	55311-41260	BAND CORD	6				0.007	0.0154

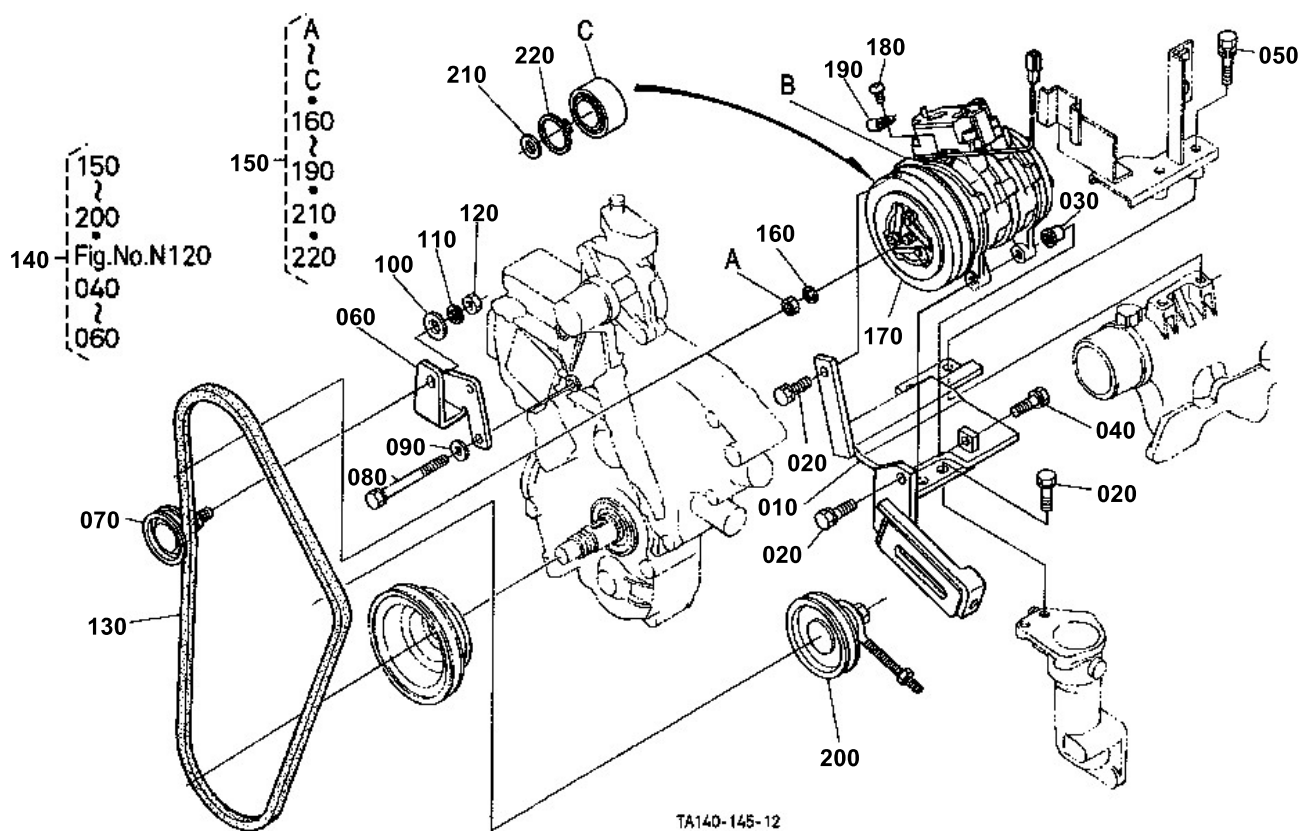



## COMPRESSOR [CAB TYPE]

↔ Interchangeable; ≠ not interchangeable; ← new for old; → old for new

REF.No	Part No.	Description	Q'ty	S.No.	I/C	REMARKS	Weight (kgf)	Weight (lb)
010	T0270-72312	BRACKET COMPRESSOR	1				1.88	4.136
020	01123-50825	BOLT	4				0.013	0.0286
030	T0270-72320	BUSH COMPRESSOR	1				0.015	0.033
040	01123-50835	BOLT	1				0.02	0.044
050	01123-50850	BOLT	2				0.02	0.044
060	34070-72343	SUPPORT PULLEY	1				0.215	0.473
070	33760-50090	PULLEY TENSION	1				0.135	0.297
080	01123-50895	BOLT	2				0.04	0.088
090	04012-50080	WASHER PLAIN	2				0.001	0.0022
100	04011-50140	WASHER PLAIN	1				0.007	0.0154
110	04512-60100	WASHER SPRING	1				0.002	0.0044
120	02114-50100	NUT	1				0.005	0.011
130	34070-79320	V BELT	1				0.16	0.352
140	TA240-87020	KIT AIR CONDITIONER	1				9.1	20.02
150	T0070-87290	COMPRESSOR	1				4.95	10.89
160	13801-94100	WASHER SPRING	1				0.002	0.0044
170	T0070-87310	ASSY CLUTH MAGNETIC	1				1.5	3.3
180	T0070-87320	SCREW WITH WASHER	1				0.003	0.0066
190	T0070-87330	CLAMP WIRE	1				0.001	0.0022
200	36530-50092	PULLEY TENSION	1				0.507	1.1154
210	T0070-87340	SHIM	1			0.10mm	0.001	0.0022
210	T0070-87350	SHIM	1			0.15mm	0.001	0.0022
210	T0070-87360	SHIM	1			0.40mm	0.001	0.0022
210	T0070-87370	SHIM	1			0.60mm	0.001	0.0022
210	T0070-87380	SHIM	1			1.00mm	0.001	0.0022
220	T0070-87440	CIR CLIP	1				0.005	0.011