

Service Bulletins
☒ Keywords to search for existing questions/answers

☐ View by series / model Note: Can be sorted by "Year", "Series" or "Failure code" by clicking on the arrows in the header bar.

☐ AG Only - Legacy (2020 and older) AG bulletins

☐ CE Only - Legacy (2020 and older) CE bulletins

☐ TSB Only - Technical Service Bulletins*

☐ MSC Only - Mandatory Service Campaigns*

☐ TIB Only - Technical Information Bulletins*

A **Service Bulletin** is a formal advisory to dealers on Kubota approved recommended repairs, update to repair techniques or troubleshooting strategies. It can also be used to inform dealerships about improved parts, service manual updates and Mandatory Field Campaigns. The ultimate purpose of service bulletins is to improve the reliability and or the performance of the equipment.

*These 3 categories only contain bulletins published in 2021 or later. For any campaigns or bulletins posted in 2020 or earlier, please use the AG/CE categories.

SERVICE BULLETIN

No: **AG023 - 10**
 Series: **L-series, M-series**
 Fail Code: **TOOL**
 Date: **06/28/2010**
 Issued by: **Nilil Sauvé**

Director, Service & Engineering

Subject:	4WD Shaft Sleeves, Bearing & Seal Installing Tool Kit >> MANDATORY TOOL <<	
Model(s):	L3130, L3430, L3830, L4330, L4630, L5030, L3240, L3540, L3940, L4240, L4740, L5240, L5740, L39, L4400, L45, M59, MX4700, MX5100 Hydrostatic Tractors	
Serial Ranges:	L30 Series HST L40 Series HST L39 HST L4400 HST L45 HST M59 HST MX4700 HST MX5100 HST	All / Tous All / Tous All / Tous All / Tous All / Tous All / Tous All / Tous All / Tous

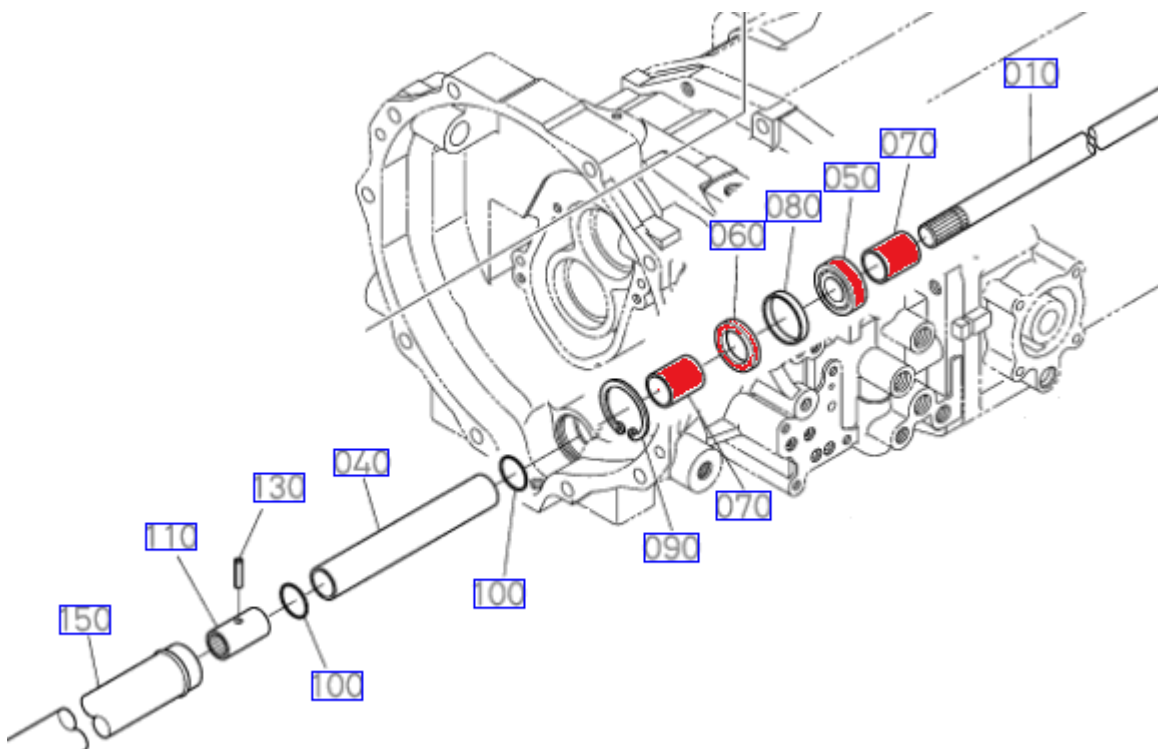

Service Information:

To facilitate and speed up the installation process (after tractor has been split) of the two sleeves (Item # 070), the seal (Item # 060) and the bearing (Item # 050). Kubota has designed a special tool kit for all the tractor models (with hydrostatic transmission) listed above.

This bulletin will provide you with installation instructions along the kit and the parts involved.

Assembly of the 4WD Shaft Sleeves, Bearing and Seal using the special tool A or B.

Note Please use these instructions in addition to the information found in the workshop manual.

- 1- Make sure propeller shaft (Item # 100) is properly installed in coupling (Item # 080) at the back of the transmission.
- Note: No roll pin is used in this rear coupling (even if there is a location for one). The front propeller shaft (Item # 100) should be in contact with the rear output drive shaft (Item # 090).
- 2- Slide the first sleeve (Item # 030) using tool until tool rests against bearing bore in HST housing.
- 3- Slide bearing (Item # 070) over the shaft until you reach the housing, then gently tap it in using the tool.
- 4- Slide spacer (Item # 060).
- 5- Slide oil seal (Item # 050) using tool. Do **not** install second sleeve before oil seal.
- 6- Install internal snap ring (Item # 040) inside HST housing.
- 7- Install second sleeve (Item # 030) inside the oil seal using tool and make sure seal lip is properly lubricated before doing so. Make sure seal lip is properly positioned after installation. Sleeve has to be in contact with bearing (Item # 070).
- 8- Install o-ring (Item # 010).
- 9- Install spacer propeller shaft (Item # 020).
- 10- Install second o-ring (Item # 010).

#	DESCRIPTION	PART NUMBER
010	O-ring	TA040-82180, 04817-00250, 04817-07230
020	Spacer Propeller Shaft	32791-14720, TC250-14720
030	Sleeve	52600-15550, TC250-14680
040	Snap Ring	04611-00240
050	Oil Seal	09500-28427, TC350-14670
060	Spacer	TD060-14654
070	Bearing	TC060-14590, 08101-06905
080	Coupling (Center & Rear) * No Roll Pin in Rear Coupling	T0070-14710, 3A021-44520
090	Drive Shaft	TD170-15210, TC250-15220
100	Propeller Shaft	TD060-14643, TC250-14640
110	Cover Shaft Rear	32791-14580, TA150-14580
120	Flywheel Housing Section	N/A
130	HST Section	N/A

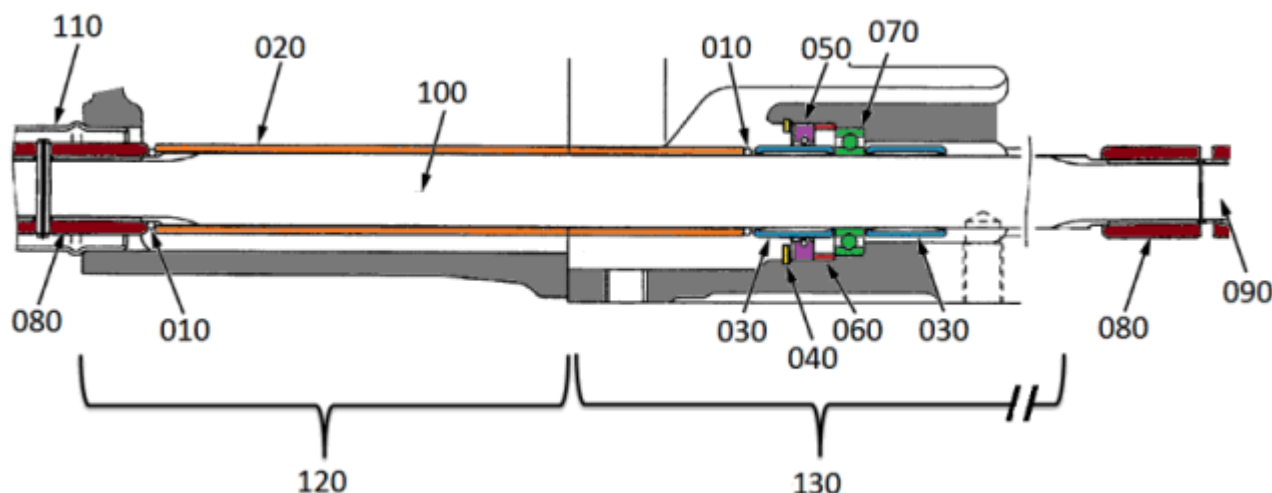

Parts Information:

ITEM #	PART NUMBER	DESCRIPTION	QTY
A B C	*4WDSEALINST	4WD Shaft Sleeves, Bearing & Seal Installing Tool >> MANDATORY TOOL <<	1

KIT CONTENT:

ITEM #	DESCRIPTION	QTY
A	Installing Tool for MX Series HST Tractors 4WD Shaft Sleeves, Bearing & Seal	1
B	Installing Tool for all L Series HST & M59 Tractors 4WD Shaft Sleeves, Bearing & Seal	1
C	Extension tool to be used in coordination with A or B To remove 4WD Shaft Sleeves	1



Warranty Information:

Does not apply