

**LA480-C : BKIDA0391 : B00502 : B00502 CONTROL VALVE
[COMPONENT PARTS] ## [REMOTE VALVE TYPE L2076]**

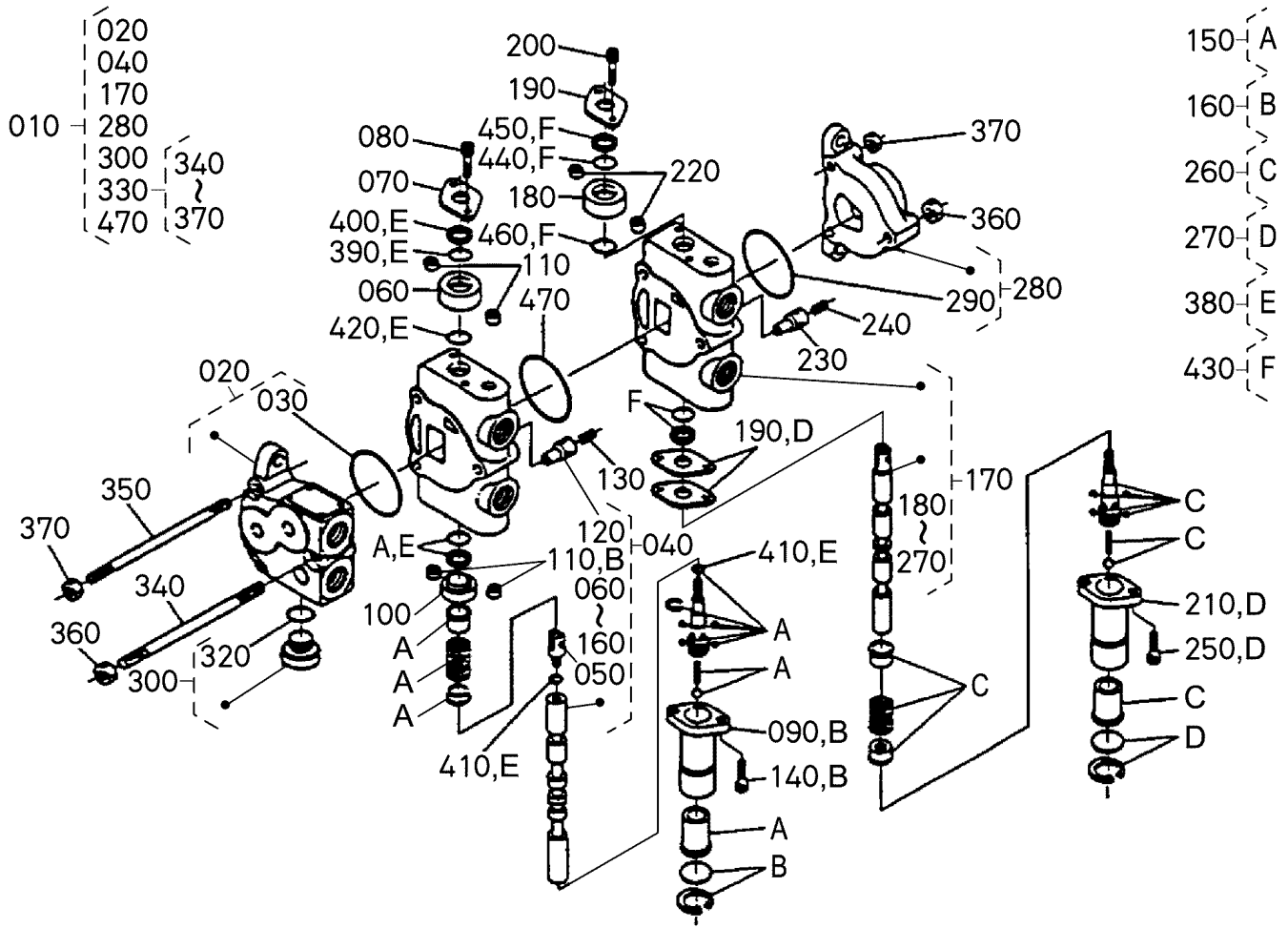

75549-010-12

| Item Number | Part Number | Description | Qty | Serial Number | Remarks | Lbs | KG |
|-------------|-------------|-------------------------|-----|---------------|---------|---------|-------|
| 010 | 7555371010 | VALVE,CONTROL | 1 | | | 18.0400 | 8.200 |
| 020 | 7554061200 | ASSY INLET SECTION | 1 | | | 3.0800 | 1.400 |
| 030 | 7554061250 | O-RING | 1 | | | 0.0220 | 0.010 |
| 040 | 7554061300 | ASSY SPOOL SECTION 1 | 1 | | | 5.7200 | 2.600 |
| 050 | 7554061310 | CLEVIS END | 1 | | | 0.0308 | 0.014 |
| 060 | 7554061320 | SPACER- CAP,SPOOL | 1 | | | 0.1100 | 0.050 |
| 070 | 7554061330 | PLATE-SEAL | 1 | | | 0.0264 | 0.012 |
| 080 | 7554061340 | CAP SCREW- SOC.HD. | 2 | | | 0.0022 | 0.001 |
| 090 | 7554061350 | CAP,SPOOL | 1 | | | 0.1540 | 0.070 |
| 100 | 7554061360 | SPACER- | 1 | | | 0.1100 | 0.050 |

| | | | | | | | |
|-----|------------|----------------------|---|--|--|--------|-------|
| | | CAP,SPOOL | | | | | |
| 110 | 7554061370 | SPACER | 4 | | | 0.0308 | 0.014 |
| 120 | 7554061380 | POPPET-C.V. | 1 | | | 0.0044 | 0.002 |
| 130 | 7554061390 | SPRING | 1 | | | 0.0022 | 0.001 |
| 140 | 7554061410 | CAP SCREW-SOC.HD. | 2 | | | 0.0220 | 0.010 |
| 150 | 7554061420 | KIT DETENT | 1 | | | 0.2200 | 0.100 |
| 160 | 7554061430 | KIT CAP,SPOOL SEC.1 | 1 | | | 0.4400 | 0.200 |
| 170 | 7555371400 | ASSY SPOOL SECTION 2 | 1 | | | 5.5000 | 2.500 |
| 180 | 7554061320 | SPACER-CAP,SPOOL | 1 | | | 0.1100 | 0.050 |
| 190 | 7554061330 | PLATE-SEAL | 3 | | | 0.0264 | 0.012 |
| 200 | 7554061340 | CAP SCREW-SOC.HD. | 2 | | | 0.0022 | 0.001 |
| 210 | 7554061350 | CAP,SPOOL | 1 | | | 0.1540 | 0.070 |
| 220 | 7554061370 | SPACER | 2 | | | 0.0308 | 0.014 |
| 230 | 7554061380 | POPPET-C.V. | 1 | | | 0.0044 | 0.002 |
| 240 | 7554061390 | SPRING | 1 | | | 0.0022 | 0.001 |
| 250 | 7555371450 | CAP SCREW-SOC.HD. | 2 | | | 0.0220 | 0.010 |
| 260 | 7555371460 | KIT INTERNAL | 1 | | | 0.2376 | 0.108 |
| 270 | 7555371470 | KIT CAP,SPOOL SEC.2 | 1 | | | 0.2420 | 0.110 |
| 280 | 7554061500 | ASSY OUTLET SECTION | 1 | | | 2.4420 | 1.110 |
| 290 | 7554061250 | O-RING | 1 | | | 0.0220 | 0.010 |
| 300 | 7554061600 | ASSY PLUG | 1 | | | 0.1320 | 0.060 |
| 320 | 7554061620 | O-RING | 1 | | | 0.0022 | 0.001 |
| 330 | 7554061700 | KIT TIE ROD | 1 | | | 0.3520 | 0.160 |
| 340 | 7554061710 | TIE ROD | 1 | | | 0.1760 | 0.080 |
| 350 | 7554061720 | TIE ROD | 1 | | | 0.1100 | 0.050 |
| 360 | 7554061730 | NUT-SPECIAL | 2 | | | 0.0440 | 0.020 |
| 370 | 7554061740 | NUT-SPECIAL | 4 | | | 0.0022 | 0.001 |
| 380 | 7554099700 | KIT SEAL,SPOOL SEC.1 | 1 | | | 0.0022 | 0.001 |
| 390 | 7554099710 | O-RING | 2 | | | 0.0044 | 0.002 |
| 400 | 7554099720 | WIPER | 1 | | | 0.0044 | 0.002 |
| 410 | 7554099730 | O-RING | 2 | | | 0.0022 | 0.001 |
| 420 | 7554099740 | O-RING | 2 | | | 0.0022 | 0.001 |
| 430 | 7554099800 | KIT SEAL,SPOOL SEC.2 | 1 | | | 0.0022 | 0.001 |
| 440 | 7555399810 | O-RING | 2 | | | 0.0022 | 0.001 |
| 450 | 7554099720 | WIPER | 2 | | | 0.0044 | 0.002 |
| | | | | | | | |

| | | | | | | | |
|-----|------------|--------|---|--|--|--------|-------|
| 460 | 7554099740 | O-RING | 1 | | | 0.0022 | 0.001 |
| 470 | 7554061250 | O-RING | 1 | | | 0.0220 | 0.010 |